

# PUMA

**AUTOMATIC  
VERTICAL NETTING  
MACHINE**

**MAQUINA  
ENMALLADORA  
VERTICAL**



Phone 559.636.9600

Fax 559.636.9603

[www.MainLineIndustry.com](http://www.MainLineIndustry.com)

## PUMA · AUTOMATIC VERTICAL NETTING MACHINE WITH THERMO-WELDED LABELS

The Puma is a vertical machine that welds material together without the use of metal clips, making it an excellent choice in the move towards sustainability. It creates net packages with much less material than traditional netting machines. The packs are made with "mono-material" and can be recycled. Packages can be made with a wineglass type label or a strap welded end to end. The automatic tube rotation keeps you running strong, and you can print data and text on each package with an optional printer.

**Scope of Product:** Citrus, avocados, onions, potatoes, and other fruits & vegetables

### Technical details:

- 7" color touch screen control panel
- 10.1" touch screen for Markem X45 printer - Sustainable packaging made of tubular net and only one label, w2w or wineglass label
- The dimensions and shapes of the labels can be widely customized
- Double net tube with automatic tube change - Water cooling for net weld to help with faster speeds.
- Infeed hopper with buffer (pneumatic flap) and anti-clog system that prevents product build-up
- Soft padding for gentle product drop
- Outfeed flat belt can run left or right
- All parts that come in contact with product are food-grade
- Low energy consumption using mechanical actuators (piston)
- Minimum/maximum pack weight is 100g to 2.5kg
- Production rate: 37 packs/ minute (depending on product)

## PUMA · MAQUINA ENMALLADORA VERTICAL CON SOLDACION DE ETIQUETAS

La Puma es una maquina enmalladora que suelda etiquetas sin el uso de grapas de metal. Es por eso que la maquina puma es una buena opción para realizar paquetes sostenibles. La máquina genera paquetes con menos material que paquetes tradicionales de malla. Los paquetes son hechos de "monomaterial" y pueden ser reciclados. Los paquetes también se pueden generar con etiquetas estilo corbata o un cinto lado a lado en las clausuras. La rotación automática del tubo mantiene que la máquina funcione fuerte. Con una impresora opcional se puede poner información y fechas en cada paquete.

**Alcance del producto:** fruta cítrica, aguacates, cebollas, papas, y otras frutas y vegetales.

### Technical details:

- 7" color touch screen control panel
- 10.1" touch screen for Markem X45 printer - Sustainable packaging made of tubular net and only one label, w2w or wineglass label
- The dimensions and shapes of the labels can be widely customized
- Double net tube with automatic tube change - Water cooling for net weld to help with faster speeds.
- Infeed hopper with buffer (pneumatic flap) and anti-clog system that prevents product build-up
- Soft padding for gentle product drop
- Outfeed flat belt can run left or right
- All parts that come in contact with product are food-grade
- Low energy consumption using mechanical actuators (piston)
- Minimum/maximum pack weight is 100g to 2.5kg
- Production rate: 37 packs/ minute (depending on product)

## OPTIONS FOR THE PUMA

- Net tubes can be ordered in different diameters
- V-belt for inline packaging
- Remote assistance

## OPCIONES PARA LA PUMA

- Tubos para la malla de diferentes medidas
- Banda estilo V para mantener empaquetado en línea
- Asistencia remota

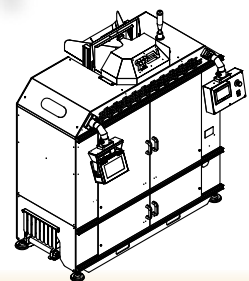
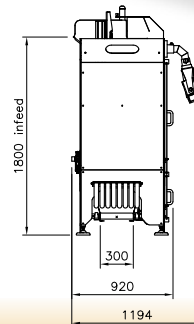
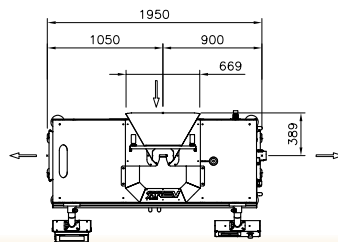
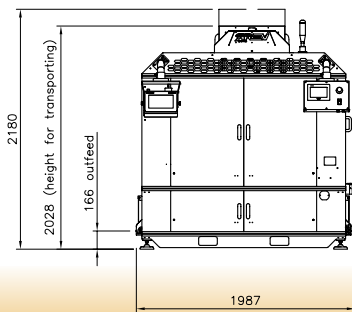

Manufactured in Italy

**Feeding systems and other customized options can be evaluated by our technical department. Varias opciones de sistemas personalizados pueden ser consultadas con nuestro departamento técnico.**

Our policy is aimed towards constant improvement and development.

We therefore reserve the right to amend the information given in this leaflet without prior notice.

Enfocamos a nuestra mejoría y desarrollo de nuestros productos. Tenemos derecho a modificar esta información sin noticia.